

Reading-Heathrow T5
40 mins during the day



Fast trains can get you into Reading Station from all over the West Country and South Wales, then it's just a short coach connection direct to Heathrow Airport.

RailAir really is the best way to the airport. The coaches are smart, stylish and extremely comfortable. Sit back and relax into plush armchair seats and take advantage of the free Wi-Fi and at-seat USB charging. Some seats are set around tables, ideal for up to four travelling together.

There's plenty of room for all your luggage in the large hold and there are additional racks inside above your seat. The driver can help you with any awkward items.

railair.com



information
railair.com
0345 646 0707
@railair

railair

& you're there



quick,
comfortable
coach link between
Reading Station &
Heathrow
Airport



DAILY
EARLY TO LATE
UP TO EVERY 30 MINS

from 8 January 2023

tickets
railair.com



RailAir coaches drop you off right outside Terminals 2, 3 and 5.

Here's how to find RailAir coaches for the journey to Reading Station.

from Terminals 2 & 3

Follow signs to Central Bus & Coach Station.

from Terminal 5

Follow the signs to local buses - go to stand 9.

using Terminal 4?

Inter-terminal transfer is free by train, Underground and H30 bus. Use Oyster or contactless for trains and Underground (you won't be charged).



Where to find the RailAir lounge and coach stop at Reading Station.

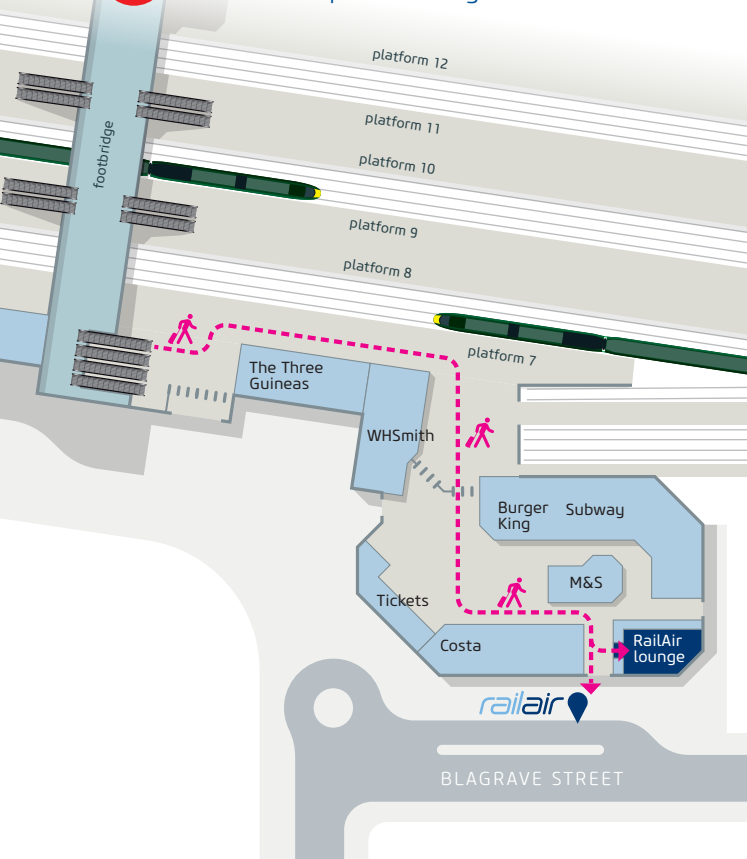

Reading to Heathrow

RA1

Reading railway station	0246	0400	0500	0530	0600	0630	0700	0730	0800	0830	then every 30 mins	00 30	until	1900	1930	2000	2030	2100	2200	2300
Reading Cemetery Junction	0250	0404	0504	0534	0604	0635	0705	0735	0805	0835		05 35		1905	1934	2004	2034	2104	2204	2304
Heathrow Terminal 5	0340	0436	0536	0606	0636	0713	0743	0813	0843	0910	40 10	1940	2006	2036	2106	2136	2236	2336		
Compass Centre Newbury Rd	0346	0442	0542	0612	0642	0719	0749	0819	0849	0916	46 16	1946	2012	2042	2112	2142	2242	2342		
Heathrow Terminal 2	0353	0449	0549	0619	0649	0726	0756	0826	0856	0923	53 23	1953	2019	2049	2119	2149	2249	2349		
Heathrow Terminal 3	0358	0454	0554	0624	0654	0731	0801	0831	0901	0928	58 28	1958	2024	2054	2124	2154	2254	2354		
Heathrow Central Bus Station	0402	0458	0558	0628	0658	0735	0805	0835	0905	0932	02 32	2002	2028	2058	2128	2158	2258	2358		

Heathrow to Reading

RA1

Heathrow Central Bus Station	0415	0515	0615	0645	then every 30 mins	15 45	until	1545	1615	1645	1715	1745	1815	1845	1915	1945	2015	2040	2110
Compass Centre stop BW	0421	0521	0621	0651		21 51		1551	1621	1651	1721	1751	1821	1851	1921	1951	2021	2046	2116
Heathrow Terminal 5	0429	0529	0629	0701	31 01	1601	1631	1701	1731	1801	1831	1901	1929	1959	2029	2054	2124		
Reading Cemetery Junction	0501	0601	0701	0736	06 36	1636	1709	1739	1809	1839	1909	1939	2001	2031	2101	2126	2156		
Reading railway station	0506	0606	0707	0742	12 42	1642	1715	1745	1815	1845	1915	1944	2006	2036	2106	2131	2201		

Heathrow Central Bus Station	2140	2210	2310	0010
Compass Centre stop BW	2146	2216	2316	0016
Heathrow Terminal 5	2154	2224	2324	0024
Reading Cemetery Junction	2226	2256	2356	0055
Reading railway station	2231	2301	0001	0101

this coach also stops at
Twyford Waitrose 0301
Maidenhead railway station 0317

check the website for
 Christmas & Easter holiday times

fares

We have a range of fares, including discounts for under-16s and groups of up to 4 people travelling together.

The best prices are always online and you can book up to 5pm on the day before you want to travel - just bring the printout or show on your phone when you board the coach.

commute to Heathrow?

Save money with our great-value season tickets

all prices railair.com

We also have walk-up fares available from the RailAir lounge at Reading Station or from the driver when you board.

Pay cash or contactless.

if you work at the airport go to heathrow.com/commuter for great ways to save even more

